

## Basic Functions - App Menu

### 1 Touch Apps Menu.

From the Home screen, select Apps Menu icon at the bottom to access the application list.



### 2 Select the application you would like to open.

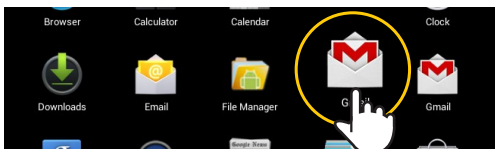

### 3 Select the Back Key to return to the previous screen. Select the Home Key to return to the Home screen.

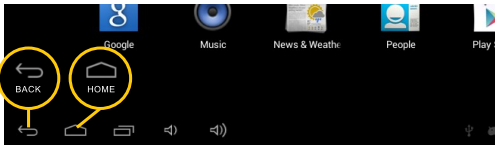

Model:M750D2

## Personalize Your M750D2

### Set Up Email

#### 1 From the Home screen select "Email".

#### 2 Enter your email address, password and tap "Next".

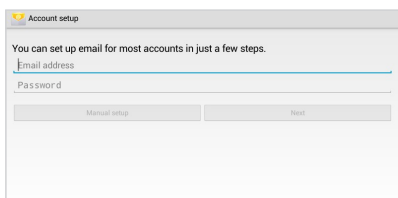

#### 3 Select which type of email account you are setting up and complete settings. (POP3/IMAP/MICROSOFT Exchange Account)

You will need to enter your user name, password and server information depending on the type of email account, or you can change the settings by tapping "Manual Setup" at the top right corner of the screen. Tap "Next" and select "OK" to accept the activation.

### Change Wallpaper

#### 1 Press and hold on a blank spot on the home screen and a menu will show up.

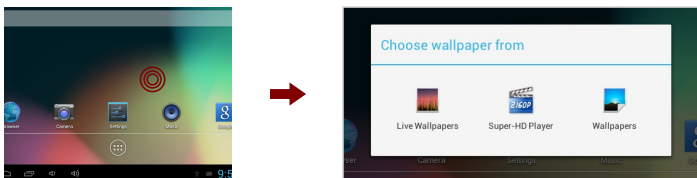

Select from pictures in your gallery or the pre-loaded live and standard wallpapers. Once selected, tap "Set Wallpaper."

Model:M750D2

## Connect Between Tablet & Computer

### 1 Connect the enclosed Micro USB to USB cable to your tablet and computer.

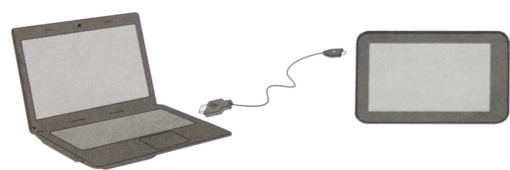

### 2 Touch "USB" icon on right bottom corner and select "USB connected".

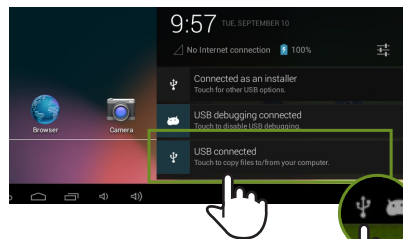

### 3 Touch "Turn on USB storage".

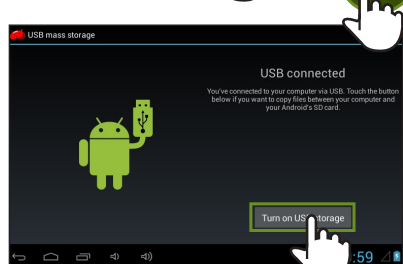

Model:M750D2

## Connect Between Tablet & Computer

### 4 Once connected successfully, select "M750D2" on your computer to review files in tablet or transfer documents between them.

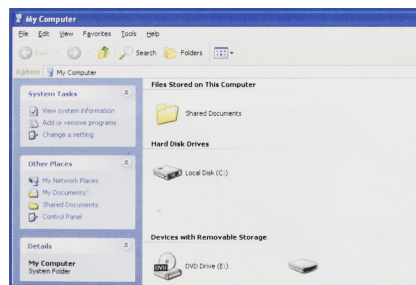

### 5 Touch "Turn off USB storage" and disconnect cable when it is finished.

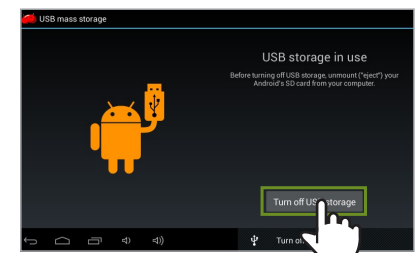

Model:M750D2

# TRAVELTEK

For a complete & detailed User Manual please refer to the following pre-installed APP.



From the Home screen, select User Manual icon at the bottom to access the User Manual.

## Quick Start Guide

M750D2

## Overview

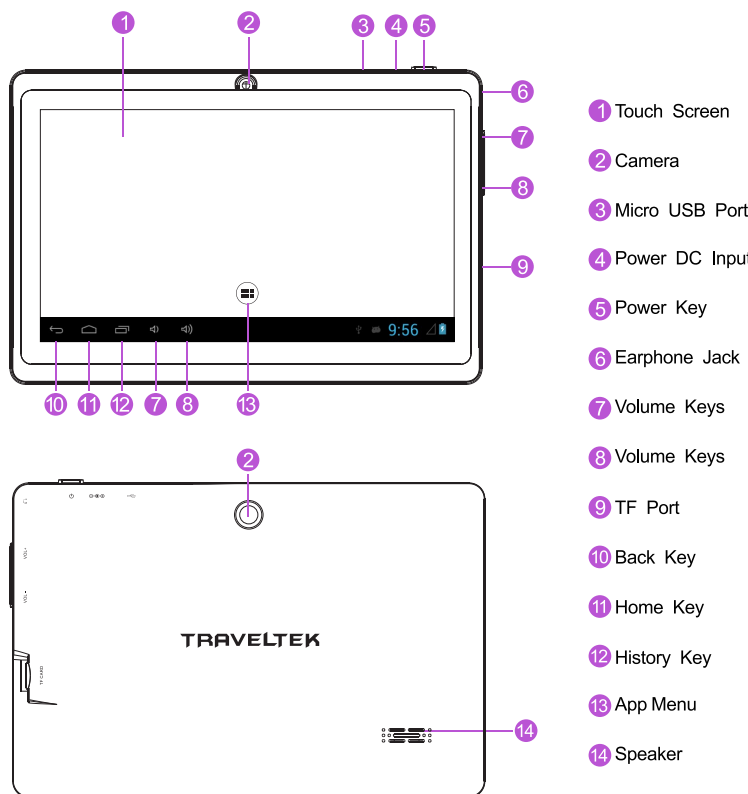

Model:M750D2

## Basic Functions - Charging

Prior to using the M750D2 for the first time, fully charge the battery. The M750D2 has a built-in polymer battery that uses only the designated charger to charge.

In order to prolong the service life of the product, use the device until the battery is depleted for the first two times before charging the battery again.

To charge the battery, connect the charger/adaptor to the device and the DC jack.



#### NOTE:

- For the first two times of charging the battery, the charger time may be up to 10 hours; succeeding times may take up to 5 hours.
- When charger is plugged in after the product shuts down due to low power, it may take a few moments before the product enters the home screen.
- The polymer battery cells in the battery pack are not user-serviceable.

When the device is not in use, be sure to turn it off.

If the device will not be used for a long period of time, be sure to discharge and then recharge the battery once a month.

The built-in polymer battery must be recharged regularly. Battery damage caused by depletion or the use of unauthorized charger is not covered by the warranty.

Model:M750D2

## Basic Functions - Power On

### 1 Press the power button to power on.

To power on your M750D2, press and hold the power button for a few seconds until the Android logo appears.

### 2 Slide the Unlock icon to awaken screen.



### 3 Press and hold the Power button for 5 seconds, then a "Power off" dialog box will pop up.

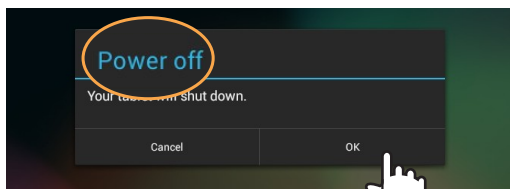

#### Troubleshooting:

If your M750D2 has an error or freezes, you may need to "reset" your M750D2 to regain functionality.

If your device is frozen and unresponsive, press and hold the POWER Key for 10-15 seconds to Power Off.

Model:M750D2

## Basic Functions - WIFI

### 1 Select "Settings" on Home screen.

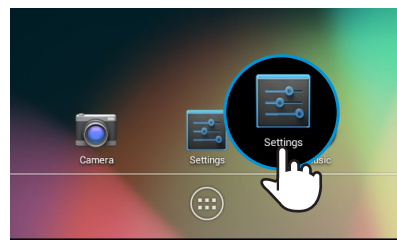

### 2 Touch Wi-Fi "OFF" to "ON".

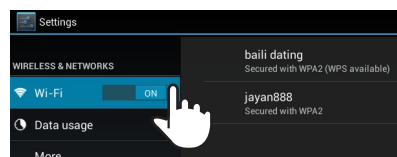

### 3 Select your designated Wi-Fi connection on list.

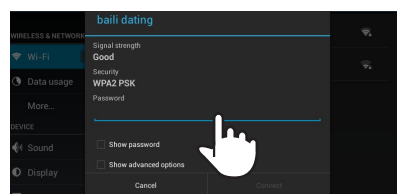

### 4 Enter the required Wi-Fi password.



Model:M750D2

### Precautions

- Avoid dropping or strong collision of the product or heavy vibration of the TFT screen, as it may cause damage or abnormal display of the TFT screen.
- This product cannot be used with any unauthorized charger, otherwise it may burn the product, which is not covered by warranty. For any additional original charger, please contact customer service at 1-800-985-7657.
- To avoid any accidents, please do not use the product when driving or walking on the street.

TRAVELTEK shall not be held liable for any loss of data caused by damage or repair of the product or any other reason. Please operate the product properly following the guidelines.

**\*\*NOTE:** Pictures in this Quick Start Guide are for reference only.