



HDD Installation Note

Required Tools for Installation

1. NetBook Travelbook P14
2. 2.5" HDD (Up to 1TB)
3. HDD fixing clamps (2 pcs.)
4. Screw Driver
5. Screw (4pcs (M3.0) - For HDD, 2pcs (M2.0) (clamps)

Step 1: Unscrew and open the HDD Cover from "D" body.

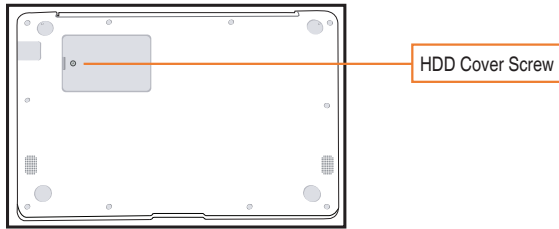

Step 2:

A) Use HDD fixing Clamps and M3.0 screws on both the sides of HDD / SSD. Fix it properly, as shown below.

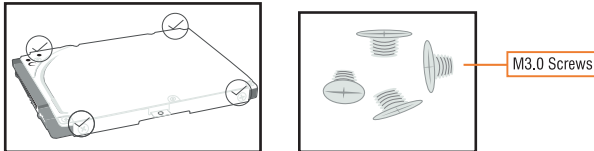

B) Insert HDD with clamps inside the OHD slot and fix it properly. Use M2.0 screws on both the sides and fix clamps with device properly.

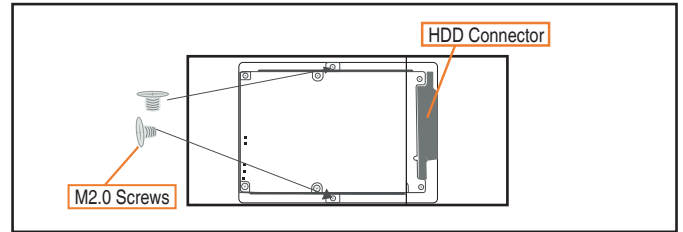

Step 3: Fix the HDD cover and tighten the screw properly.

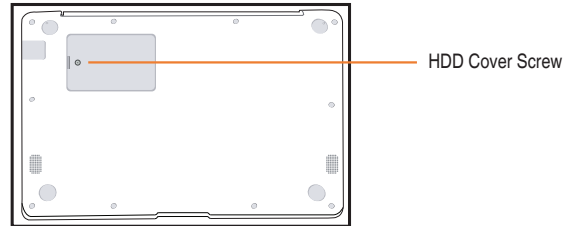

Note:

- The HDD is for storage only. Please do not install OS.
- HDD support: Form factor - 2.5 inch. Current - up to 1A. Size - up to 7mm
- When any new HDD is connected, format it before using it for the first time.
- If you are connecting the old / used HDD Drive in this device, the data / partition inside the HDD may not be accessible.
- When any new HDD is connected, it may not detect / work for the first time and you may need to restart the device twice to work it properly.
- The USB power in this device is shared among all USB ports and internal HDD / SSD. When internal HDD is connected, there may be chances of issues like slow / jerky cursor movement while using Pen drive, USB mouse or any other USB devices.
- For any technical assistance of Traveltek products, please contact support@traveltekusa.com / <http://traveltekusa.com>